

SFT SERIES (ISO)

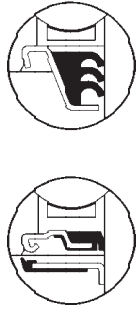

Bearing inserts with finger seals shown on pages 91 and 92 can be fitted into these housings. The unit reference has the suffix 'FS', e.g. SFT11FS.

Triple seal bearing inserts shown on pages 88 to 90 can be fitted into these housings. The unit reference has a prefix 'T', e.g. TSFT11

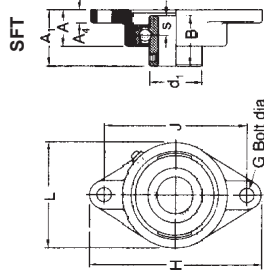

Shaft diameter	RHP designation	Basic bearing insert	Casting group	Dimensions						
				L	H	J	G	A	A ₁	
mm	inches			mm	inches					
12	SFT12	SFT12EC	1017	52.5	98.5	76.50	10	24.6	32.87	
15	SFT15	SFT15EC		2.067	3.878	3.012	3/8	969	1.294	
16	SFT16	SFT16EC								
17	SFT17	SFT17EC								
1/2	SFT1/2	SFT1/2EC								
5/8	SFT5/8	SFT5/8EC								
20	SFT20	SFT20EC	1020	60.3	111.9	90.00	10	27.8	37.26	
3/4	SFT3/4	SFT3/4EC		2.374	4.406	3.543	3/8	1.094	1.467	
25	SFT25	SFT25EC	1025	70.0	125.5	99.00	10	28.6	38.84	
7/8	SFT7/8	SFT7/8EC		2.756	4.941	3.898	7/16	1.126	1.529	
1 15/16	SFT1 15/16	SFT1 15/16EC								
1	SFT1	SFT1EC								
30	SFT30	SFT30EC	1030	82.6	141.3	116.50	10	29.8	42.21	
1 1/8	SFT1 1/8	SFT1 1/8EC		3.252	5.563	4.687	7/16	1.173	1.662	
1 3/16	SFT1 3/16	SFT1 3/16EC								
1 1/4	SFT1 1/4	SFT1 1/4EC								
35	SFT35	SFT35A	1035	95.5	155.5	130.00	12	31.4	46.41	
1 1/4	SFT1 1/4	SFT1 1/4A		3.760	6.122	5.118	1/2	1.236	1.827	
1 3/8	SFT1 3/8	SFT1 3/8EC								
1 7/16	SFT1 7/16	SFT1 7/16EC								
40	SFT40	SFT40EC	1040	101.6	171.4	143.50	12	34.9	54.18	
1 1/2	SFT1 1/2	SFT1 1/2A		4.000	6.748	5.650	1/2	1.374	2.133	
45	SFT45	SFT45A	1045	111.1	179.4	148.50	16	35.3	54.18	
1 5/8	SFT1 5/8	SFT1 5/8EC		4.374	7.063	5.846	5/8	1.390	2.133	
1 11/16	SFT1 11/16	SFT1 11/16EC								
1 3/4	SFT1 3/4	SFT1 3/4A								
50	SFT50	SFT50EC	1050	115.9	188.9	157.00	16	39.7	60.53	
1 7/8	SFT1 7/8	SFT1 7/8EC		4.563	7.437	6.181	9/8	1.563	2.283	
1 15/16	SFT1 15/16	SFT1 15/16EC								
2	SFT2	SFT2EC								
55	SFT55	SFT55DEC	1055	127.0	215.9	184.00	16	43.7	64.31	
2	SFT2	SFT2DEC		5.000	8.500	7.244	5/8	1.720	2.532	
2 1/8	SFT2 1/8	SFT2 1/8EC								
2 3/16	SFT2 3/16	SFT2 3/16EC								
60	SFT60	SFT60DEC	1060	138.1	235.0	202.00	16	47.6	73.69	
2 1/4	SFT2 1/4	SFT2 1/4EC		5.437	9.252	7.953	5/8	1.874	2.901	
2 3/8	SFT2 3/8	SFT2 3/8EC								
2 7/16	SFT2 7/16	SFT2 7/16EC								

Please check availability

A ₂	A ₃	A ₄	B	B ₁	B ₂	B ₃	s	s ₁	s ₂	d ₁	d ₂	C _r	ISO load ratings		Rec. max. speed	Mass (approx.)
													dynamic	static		
mm	inches											newtons	newtons	rev/	kg	
												lb	lb	min	lb	
39.01	1.536	9.5	27.38	28.54	11.55	6.55	24.21	28.58	7000	0.4						
		.374	1.078	1.124	.455	.258	.953	1.125	7000	0.9						
42.42	1.670	11.1	30.96	30.92	43.62	12.75	7.56	17.12	6700	0.6						
		.437	1.219	1.015	1.717	.502	2.98	674	1.311	1.3						
42.42	1.670	11.1	34.11	27.35	30.92	44.40	14.32	7.56	17.49	34.01	14.000	7880	6250	0.9		
		.437	1.343	1.077	1.217	1.748	.564	2.98	689	1.339	1.500	3150	1770	2.0		
46.66	1.837	12.7	38.10	31.21	35.68	48.42	15.93	9.04	18.32	40.00	44.45	11300	5300	1.1		
		.500	1.500	1.229	1.405	1.906	.762	3.65	721	1.575	1.750	4380	2540	2.5		
50.34	1.982	12.7	42.88	34.90	38.88	51.18	17.53	9.55	18.89	46.69	55.58	15300	4500	1.4		
		.500	1.688	1.374	1.531	2.015	.690	.376	.744	1.838	2.188	5780	3440	3.0		
56.62	2.229	12.7	49.23	41.18	43.64	56.34	19.10	11.05	21.46	52.70	60.30	17900	4000	1.9		
		.500	1.938	1.621	1.718	2.218	.752	.435	.845	2.075	2.374	6540	4020	4.1		
56.62	2.229	14.3	49.23	41.18	43.64	56.34	19.10	11.05	21.46	57.30	63.50	20500	3700	2.2		
		.563	1.938	1.621	1.718	2.218	.752	.435	.845	2.256	2.500	7310	4610	4.9		
60.60	2.386	14.3	51.59	43.54	43.64	62.70	19.10	11.05	24.65	62.20	69.85	23200	3400	2.5		
		.563	2.031	1.714	1.718	2.469	.752	.435	.970	2.449	2.750	7870	5220	5.4		
74.57	2.936	17.5	55.55	43.54	43.64	62.70	19.10	11.05	24.65	68.81	76.20	29200	3100	3.5		
		.689	2.187	1.718	1.718	2.469	.752	.435	.970	2.449	3.000	9780	6560	7.8		
80.77	3.180	17.5	65.07	43.54	43.64	62.70	19.10	11.05	24.65	75.34	84.12	35900	2800	4.3		
		.689	2.562	1.718	1.718	2.469	.752	.435	.970	2.966	3.312	11800	8070	9.5		